

EXISTING: SITE PLAN

Land between Altersea and Norton Lodge, Norton Subcourse, Norfolk, NR14 6RS



**The Furnace
The Maltings
Princes Street
Ipswich
Suffolk
IP1 1SB**

t: 01473 407911
e: enquiries@planningdirect.co.uk
w: planningdirect.co.uk



TITLE: Existing: Site Plan		
DATE: 17/02/22		
REF: 2257	DRAWING: 02	REVISION: 1
SCALE: 1:500	SHEET SIZE: A3	
DRAWN BY: AW	CHECKED BY: JC	
CONTACT: technical@planningdirect.co.uk		

CLIENT: Wayne Gaze

APPLICATION SUMMARY:

Outline planning application (all matters reserved) proposing the erection of two self-build dwelling on land to the east of Croft Road, Norton Subcourse, Norfolk.

KEY:

-  Site boundary
-  Curtilage of owned property

NOTES:

SITE AREA: 2925m²

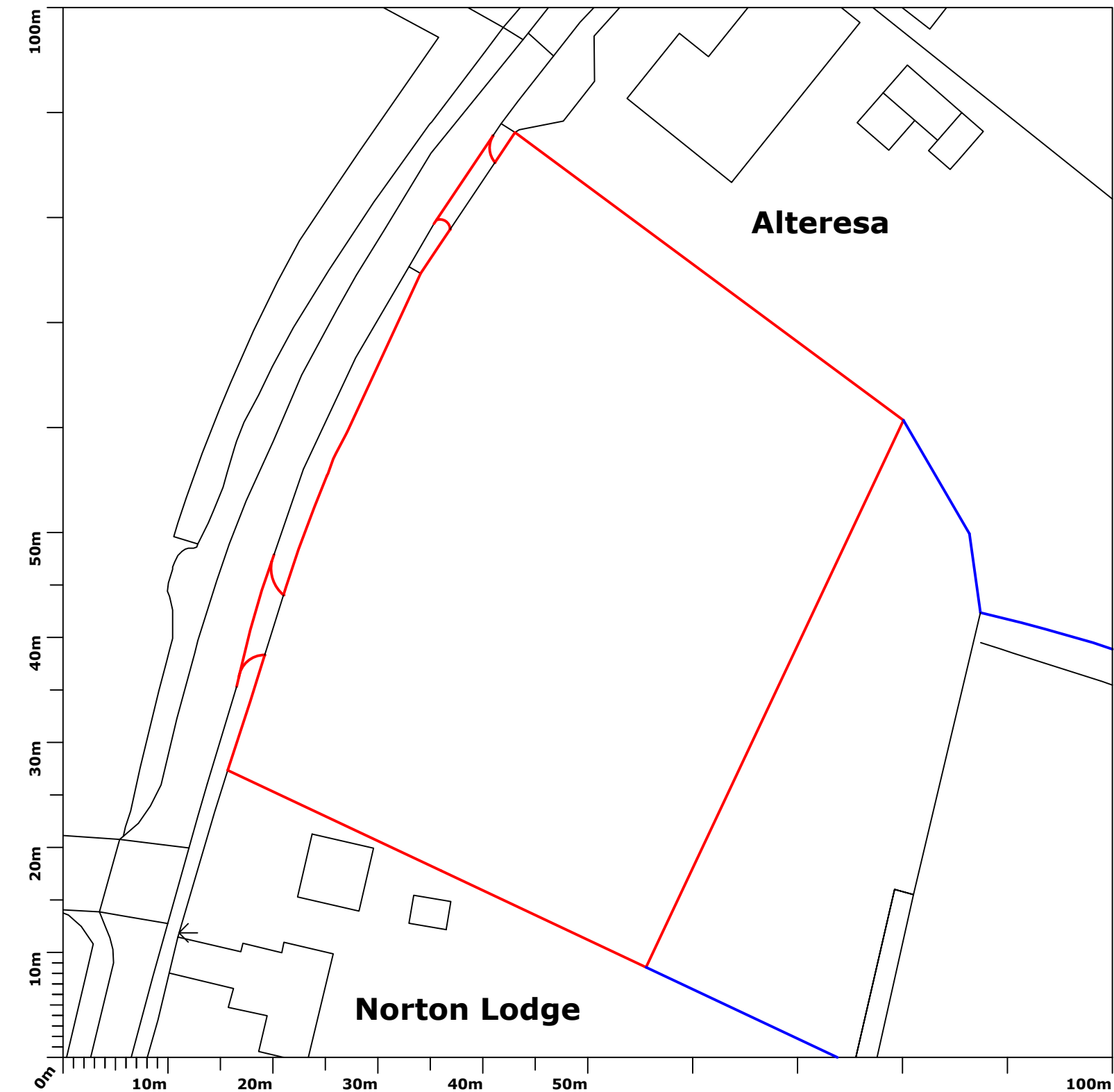

Ordnance Survey®
Ukmapcentre.com

Serial number: 258018
© Crown copyright and database right 2022
Ordnance Survey licence 100048957
Reproduction in whole or in part is prohibited
without the prior permission of Ordnance Survey

